

Specialty Fuses

Fast-Acting

GMW and HWA

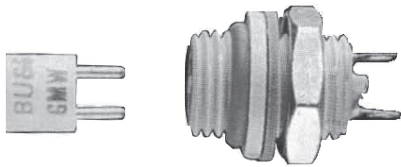

CATALOG SYMBOL: GMW (FUSE), HWA (HOLDER)

PIN TYPE

0.280" x 0.25" (7.1mm x 6.4mm)

FAST-ACTING

INTERRUPTING RATING - 35 AMPS

GMW: U.L. RECOGNIZED

(GUIDE #JDYX2, FILE # E19180)

HWA: U.L. RECOGNIZED

(GUIDE #IZLT2, FILE # E14853)

Dimensional Data

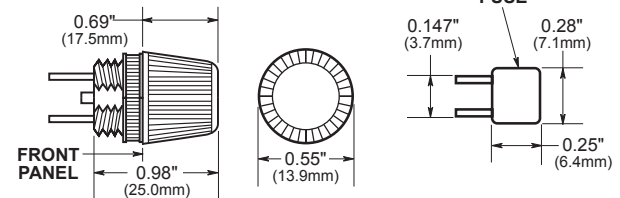

MOUNTING HOLE $\pm 0.002"$
(0.5mm)

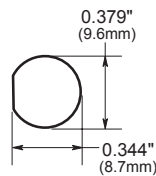

Test Specifications

Load	Opening Time
100%	4 hrs. (min.)
200%	10 sec. (max.)

Electrical Ratings (Catalog Symbol and Amperes)

125 Volts		
GMW-1/100	GMW-1/4	GMW-1-1/2
GMW-1/64	GMW-3/10	GMW-2
GMW-1/32	GMW-4/10	GMW-3
GMW-1/16	GMW-1/2	GMW-4
GMW-1/10	GMW-6/10	GMW-5
GMW-1/8	GMW-3/4	—
GMW-2/10	GMW-1	—

Carton Quantity and Weight

Ampere Ratings	Carton Qty	Weight*	
		Lbs.	Kg.
GMW 1/100-5	100	0.20	97.7
HWA Fuseholder	100	0.44	200.0
AF Knob	100	0.25	113.4

* Weight per carton.

- Sub-miniature pin-base fuses for limited space applications.
- Can be soldered direct into circuit or can be mounted in HWA holder which can be soldered into circuit.
- Transparent window in fuse for visual determination of open fuse element.
- Fuseholder body and knob material is diallyl phthalate.
- Holder includes "O"-ring, gasket, and nut.
- Military versions: fuse-FMO1; holder-FHN42W.
- Type HWA-AF holder includes waterproof cap (knob) AF.

Time-Current Characteristics—Total Clear

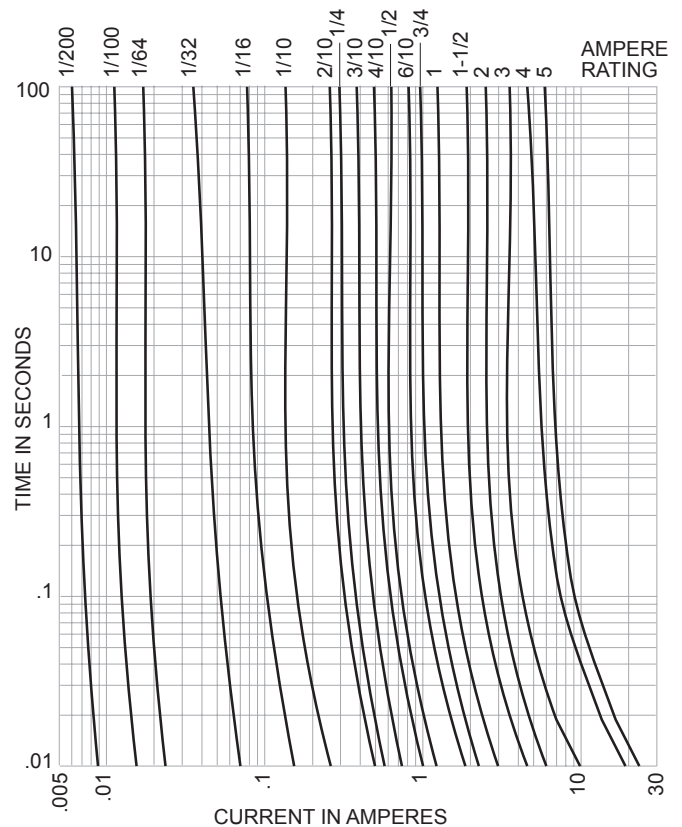

The only controlled copy of this BIF document is the electronic read-only version located on the Bussmann Network Drive. All other copies of this BIF document are by definition uncontrolled. This bulletin is intended to clearly present comprehensive product data and provide technical information that will help the end user with design applications. Bussmann reserves the right, without notice, to change design or construction of any products and to discontinue or limit distribution of any products. Bussmann also reserves the right to change or update, without notice, any technical information contained in this bulletin. Once a product has been selected, it should be tested by the user in all possible applications.